



# Technical Data

Quotation no.

Project

Date

Page 5 / 5

Customer

Positioning

Delivery time: General

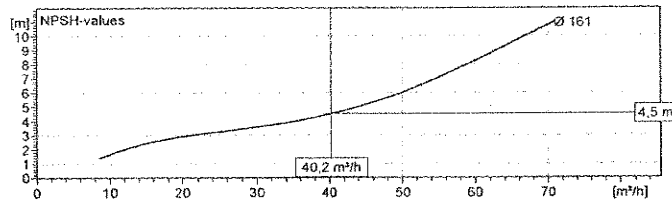
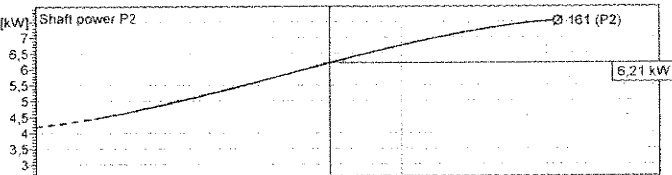
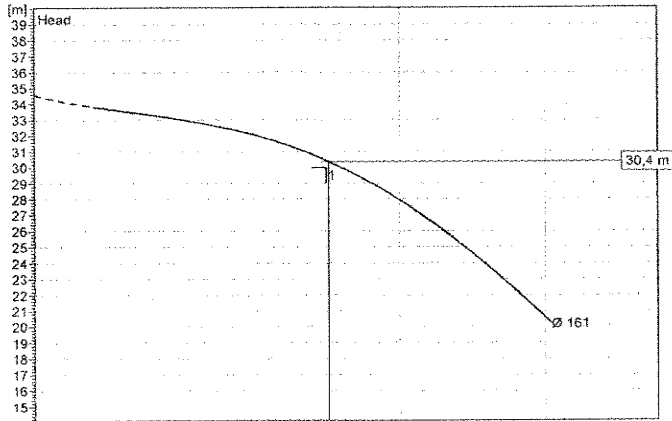

**DNs Suction side**  
EN1092/DIN

DN 65 PN 10

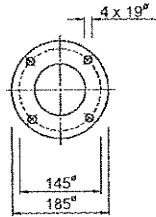

**DNd Discharge side**  
Brida

DN 65/AU-D PN 10

**Nozzles**

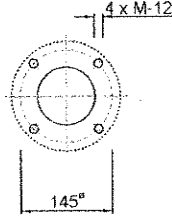

**Requested data**

Fluid Water, clean 100 %  
Temp: 20 °C Dens: 0,9983 kg/dm³ Visc: 1,005 mm²/s  
Flow 40 m³/h  
Head 30 m

**Pump data** Not allowed flammable liquid  
Type **AU-65/18**  
Design Bareshaft Pump  
Impeller type Semi-open  
Max. admissible particle size of solids 12 mm  
Max. solid / sand content 3% / 4 g/l  
Nozzles suct-disch DIN\_PN-10

ISO 9906 class 3B, below 10 kW acc. to § 4.4.2  
Flow 40,2 m³/h  
Head 30,4 m  
Speed 2920 1/min  
Efficiency 53,1 %  
Shaft power 6,21 kW

**Materials** Execution: 2103  
Pump housing Bronze (CC491K-GS)  
Pump cover Bronze (CC491K-GS)  
Impeller Bronze (CC480K-GS)  
Pump shaft Stainless Steel (A276 TYPE 316L)  
Housing wear ring Bronze (CC493K-GC)  
Support Cast Iron (EN-GJL-250)

**Shaft seal** Mechanical seal  
Type ITUR 5  
Materials / Shaft seal VBPGG

**Coupling**  
Coupling type  
Coupling protection

**Motor data** Size  
Rated power P2  
Speed  
Rated voltage  
Rated current  
Protection  
Insulation class  
Temperature class

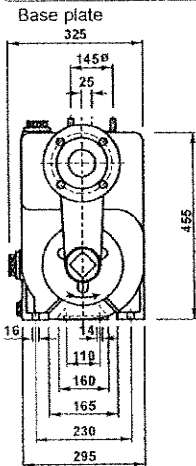
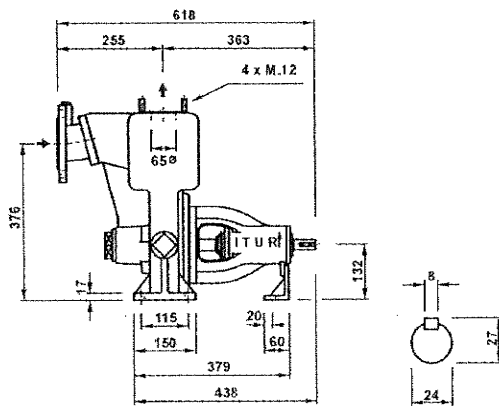

**Dimensions in mm**

DNd	65
DNs	65

Weight 80 kg

Connection dimensions for pumps: DIN 735 / ISO 2768-vK  
Dimensions w/o tolerances. Welded parts: ISO 13920-B/F  
Dimensions w/o tolerances: ISO 2768-cK  
Dimensions w/o tolerances. Castings: ISO 8062-CT9