

**ETNV125-100-315 GGSD H03901504B****Operating data**

Requested flow rate		Actual flow rate	150.00 m <sup>3</sup> /h
Requested developed head		Actual developed head	25.00 m
Pumped medium	Water, surface water River water Not containing chemical and mechanical substances which affect the materials	Efficiency	79.4 %
		Power absorbed	12.84 kW
		Pump speed of rotation	1471 rpm
Max. ambient air temperature	20.0 °C	Min. allow. flow for continuous stable operation	25.22 m <sup>3</sup> /h
Min. ambient air temperature	20.0 °C	Min. allow. mass flow for continuous stable operation	6.99 kg/s
Fluid temperature	20.0 °C	Shutoff head	30.79 m
		Max. allow. mass flow	58.95 kg/s
Fluid density	998 kg/m <sup>3</sup>	Design	Single system 1 x 100 % Tolerances to ISO 9906 Class 3B; below 10 kW acc. to paragraph 4.4.2
Fluid viscosity	1.00 mm <sup>2</sup> /s		
Mass flow rate	41.58 kg/s		
Max. power on curve	15.23 kW		

**Design**

Pump standard	EN 733	Impeller diameter	283.0 mm
Design	Close-coupled	Free passage size	19.9 mm
Orientation	Vertical	Direction of rotation from drive	Clockwise
Installation depth	398.0 mm	Silicon free pump assembly	Yes
Suction nominal dia.	DN 125	Bearing bracket construction	Standard (normal)
Suction nominal pressure	PN 16	Bearing bracket size	35
Suction position	axial	Bearing seal	V ring
Suction flange drilled according to standard	EN1092-2	Bearing type	Anti-friction bearings
Discharge nominal dia.	DN 100	Lubrication type	Grease
Discharge nominal pressure	PN 16	Color	Ultramarine blue (RAL 5002) KSB-blue
Discharge position	radial	Cover plate	Without
Discharge flange drilled according to standard	EN1092-2	Discharge pipe	Without
Contact guard	With	Max speed allowed for Immersion depth	1800 rpm
Wear ring	Casing wear ring		

**ETNV125-100-315 GGSD H03901504B****Driver, accessories**

Driver type	Electric motor	Motor enclosure	IP55
Drive standard mech.	IEC	Cos phi at 4/4 load	0.81
Model (make)	KSB-Motor	Motor efficiency at 4/4 load	92.1 %
Drive supplied by	Standard motor supplied by KSB - mounted by KSB	Temperature sensor	3 PTC resistors
Motor const. type	V1	Terminal box position	0° same orientation
Motor size	160L	Motor winding	Viewed from the drive
Efficiency class	Efficiency class IE3 acc. to IEC60034-30-1	Number of poles	400 / 690 V
Motor speed	1471 rpm	Connection mode	4
Frequency	50 Hz	Motor cooling method	Delta
Rated voltage	400 V	Motor material	Surface cooling
Rated power P2	15.00 kW	Frequency inverter operation	Aluminium
Available reserve	16.79 %	allowed	FI allowed
Rated current	30.1 A	Motor noise pressure level	68 dBa
Starting current ratio	8.9	Motor data can vary from type plate information. Motor data describes KSB's choice functional specification and is used for pump selection.	
Insulation class	F to IEC 34-1		

**Materials G****Notes 1**

General criteria for a water analysis: pH-value  $\geq 7$ ; chloride content (Cl)  $\leq 250$  mg/kg. Chlorine (Cl<sub>2</sub>)  $\leq 0.6$  mg/kg.

Volute casing (102)	Grey cast iron EN-GJL-250/A48CL35B	Casing wear ring (502.02)	Grey cast iron GG/CAST IRON
Intermediate lantern (146)	Grey cast iron EN-GJL-250/A48CL35B	Cover plate (68-3.01)	Without
Casing cover (161)	Grey cast iron EN-GJL-250/A48CL35B	Column pipe (711)	Without
Shaft (210)	Tempered steel C45+N	Support column (712)	Without
Impeller (230)	Grey cast iron EN-GJL-250/A48CL35B	Holder (732)	Steel ST
Bearing lantern (340)	Grey cast iron EN-GJL-250/A48CL35B	Tie bolt (905)	Steel 8.8
Casing wear ring (502.01)	Grey cast iron GG/CAST IRON	Nut (920.95)	Steel 8
		Key (940.01)	Steel 8

ETNV125-100-315 GGSD H03901504B

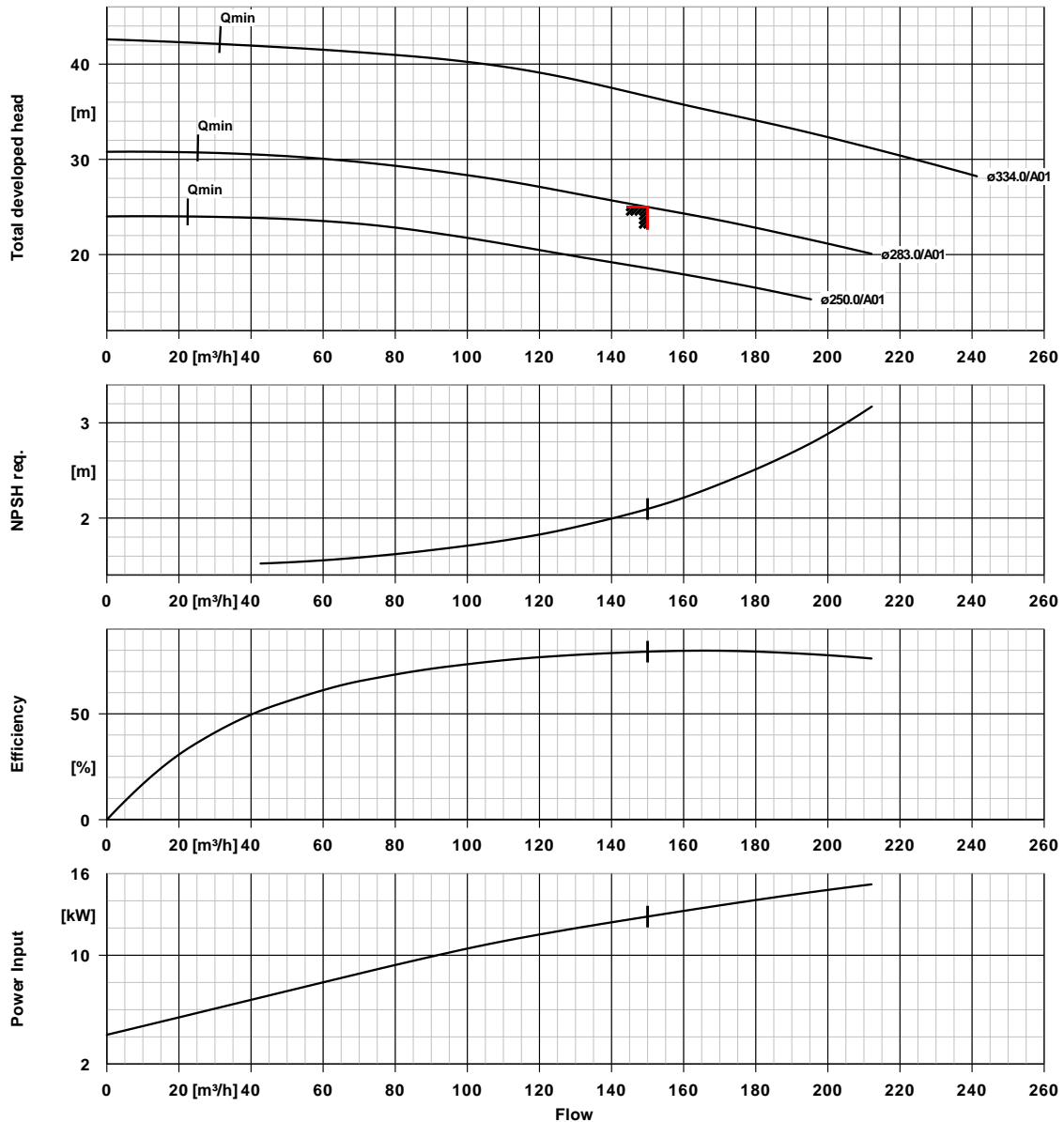

Curve data

Speed of rotation	1471 rpm	Requested developed head	25.00 m
Fluid density	998 kg/m <sup>3</sup>	Efficiency	79.4 %
Viscosity	1.00 mm <sup>2</sup> /s	Power absorbed	12.84 kW
Flow rate	150.00 m <sup>3</sup> /h	NPSH required	2.10 m
Requested flow rate	150.00 m <sup>3</sup> /h	Curve number	K1311.454/48
Total developed head	25.00 m	Effective impeller diameter	283.0 mm

ETNV125-100-315 GGSD H03901504B

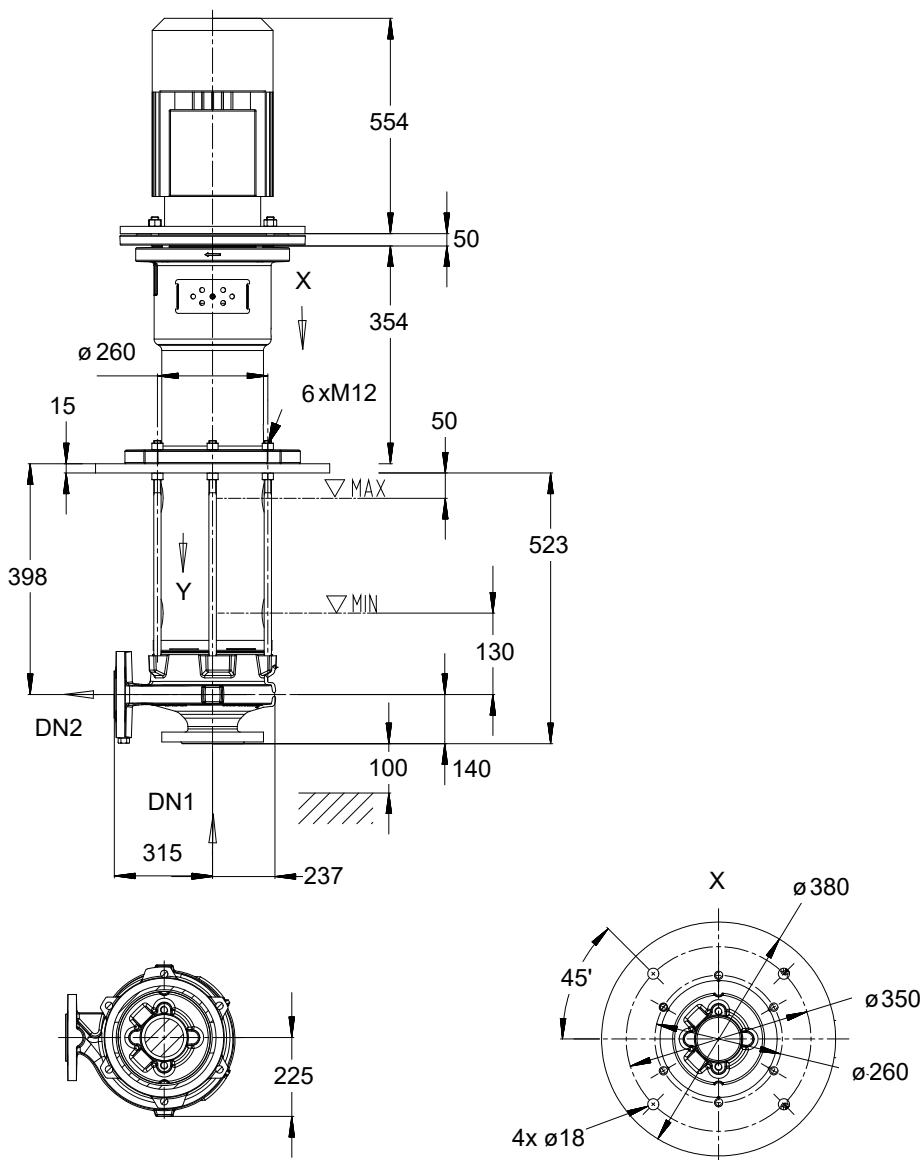

UG1483800\_D02\_006 /01

Drawing is not to scale

Dimensions in mm

**ETNV125-100-315 GGSD H03901504B**

**Motor**

Motor manufacturer	KSB-Motor
Motor size	160L
Motor power	15.00 kW
Number of poles	4
Speed of rotation	1471 rpm
Position of terminal box	0° same orientation Viewed from the drive

**Connections**

Suction nominal size DN1	DN 125 / EN1092-2
Discharge nominal size DN2	DN 100 / EN1092-2
Nominal pressure suct.	PN 16
Rated pressure disch.	PN 16

**Weight net**

Pump	255 kg
Motor	118 kg
Total	373 kg

**Connect pipes without stress or strain!**