

Etabloc 065-050-160 GG

ETB 065-050-160-GGSBV10 WSEBA4HHB

Operating point 1

Dimensioning operating point

Operating conditions (purchaser requirements)

Fluid	Water	Vapour pressure determined	-0,9766 bar.r
Fluid variant	Clean water	Minimum inlet pressure required	-0,3 bar.r
Specified fluid temperature	20 °C	Specified ambient temperature	20 °C
Density Fluid handled	998 kg/m ³	Installation altitude above sea level	1.000 m
Kinematic viscosity Fluid handled	1 mm ² /s		

Operating conditions (performance)

Flow rate	35,49 m ³ /h	Maximum power input at duty point	0,8053 kW
Minimum permissible flow rate	5,413 m ³ /h	Maximum power input / curve	0,9087 kW
Head	6,498 m	Pump speed	1.456 1/min
Shut-off head	8,115 m	Discharge pressure-max.	0,7942 bar.r
Efficiency Pump	77,86 %		
NPSH required	1,83 m		

Design data pump

Scope of supply Pump supplied by KSB	Pump + motor	Input voltage and frequency	Without
Pump standard	EN 733	Mains voltage	400 V
Shaft axis position	Horizontal	Mains frequency	50 Hz
Pump design	Close-coupled	Minimum efficiency index MEI	0,7
Pump system design	Single-pump system	Minimum permissible fluid temperature	0 °C
Specification of wetted parts	Manufactured without paint wetting impairment substances	Maximum permissible fluid temperature	60 °C
Pump direction of rotation, viewed from casing side	Counterclockwise	Quantity Stages, single-entry	1
Impeller diameter D2	148 mm	Casing wear ring design suction-side	Flat
Impeller type	Radial, closed, multi-channel	Casing wear ring design discharge-side	Flat
Free passage	11,6 mm	Installation chamber Casing cover	Conical (A-type cover)
Support foot	Yes	Bearing bracket size / shaft unit	25
		Pump bearing type, non-drive end	Anti-friction bearing
		Pump bearing type, drive end	Anti-friction bearing
		Pump directive	CE
		Explosion protection directive	Not relevant
		Pump/Valve for destination country	

Etabloc 065-050-160 GG
 ETB 065-050-160-GGSBV10 WSEBA4HHB

Nozzle connections pump

Nominal diameter Suction nozzle	DN 65	Nominal diameter Discharge nozzle	DN 50
Nominal pressure Suction nozzle	PN 16	Nominal pressure Discharge nozzle	PN 16
Suction nozzle position	Axial	Discharge nozzle position	0 deg
Suction nozzle design acc.to	EN1092-2	Discharge nozzle design acc.to	EN1092-2
Suction flange bolt hole pattern as per standard	EN1092-2	Discharge flange bolt hole pattern as per standard	EN1092-2
Flange facing type Inlet	Raised face (B,RF)		
Flange facing type Outlet	Raised face (B,RF)		

Auxiliary connections pump

6B Fluid Drain	G 1/4 Drilled and plugged	1M Pressure gauge Discharge nozzle	Without Without
6D Fluid Filling and venting	G 1/4 Drilled and plugged	1M Pressure gauge Suction nozzle	Without Without
5B Venting and drain	G 1/4 Drilled and plugged		

Shaft sealing

Shaft seal type	SMS A-type cover, vented	Shaft seal code	Code 10
Operating mode of mechanical seal (function)	API plan 03	Shaft seal manufacturer inboard	KSB's choice
Determined pressure Seal chamber	-0,25 bar.r	Mechanical seal type inboard	KSB's choice
		Material Shaft seal inboard	QQXGG

Special design

Variant shaft seal

Etabloc 065-050-160 GG

ETB 065-050-160-GGSBV10 WSEBA4HHB

Materials

Material Volute casing (102)	EN-GJL-250/A48 CL 35B	Material Bolts/Screws Volute casing (902.01)	8.8
Material Casing cover (161)	EN-GJL-250/A48 CL 35B	Material Nut Impeller fastening (920.95)	(ST)
Material Shaft	C45+N		
Material Impeller (230)	EN-GJL-250/A48 CL 35B		
Material Casing wear ring suction-side (502.01)	JL/LAMELLAR GRAPHITE CAST IRON		
Material Casing wear ring discharge-side (502.02)	JL/LAMELLAR GRAPHITE CAST IRON		
Material Shaft protecting sleeve (523)	(CRNIMO ST INT)		
Material Static seal Discharge cover	DPAF DW001		
Material Drive lantern	EN-GJL-250/A48 CL 35B		

Driver

Electric motor	Yes	Rated speed Motor	1.440 1/min
Drive concept	Electric actuator	Number of motor poles	4
Drive standard, mechanical	IEC	Rated power Motor	1,1 kW
Drive standard electric	IEC	Motor power reserve determined	36,6 %
Motor bearing, insulated	No	Rated voltage Motor	400 V
Motor manufacturer	KSB's choice	Motor winding	230 / 400 V
Customer supply Drive	No	Rated frequency Motor	50Hz
Motor construction type	IM V1 (IM3011) IEC 60034-7	Motor switching type	Star
Motor size	90S	Rated current Motor	2,64 A
Efficiency class	IE3 (Premium)	Starting current ratio Ia/In	8
Material motor housing	AL	Cos phi at 4/4 load	0,83
Enclosure Motor	IP55	Motor efficiency at 4/4 load	84,1 %
Enclosure Unit	Without	Explosion protection directive Drive for destination country	Not relevant
Thermal class	155 (F) nach IEC 60085	Marking according to directive Drive	CE
Temperature sensor motor	1 PTC thermistors	Marking according to directive Drive for destination country	Not relevant
Terminal box position of motor (looking at the motor shaft)	360 °		
Operation on a frequency inverter permitted	Yes (acc to motor manufact)		
Sound pressure level Motor	59 dBa		
Type series Motor manufacturer	Acc. to motor manufacturer		



Etabloc 065-050-160 GG

ETB 065-050-160-GGSBV10 WSEBA4HHB

Coating

Aggregate

Surface preparation

Properties Primer coat

Thickness Primer coat

Properties Top coat

Thickness Top coat

Colour Top coat

Free from dirt, grease, rust

Hydro dip primer, water-dilutable

60 µm

Acrylate dispersion water-thinned

40 µm

RAL5002 Ultramarine Blue

Packaging

Suitable for transport

Suitable for storage

Packaging category

Truck transport

Indoor storage

KSB's choice (A0)

Nameplates

Duplicate name plate

No

Etabloc 065-050-160 GG
 ETB 065-050-160-GGSBV10 WSEBA4HHB

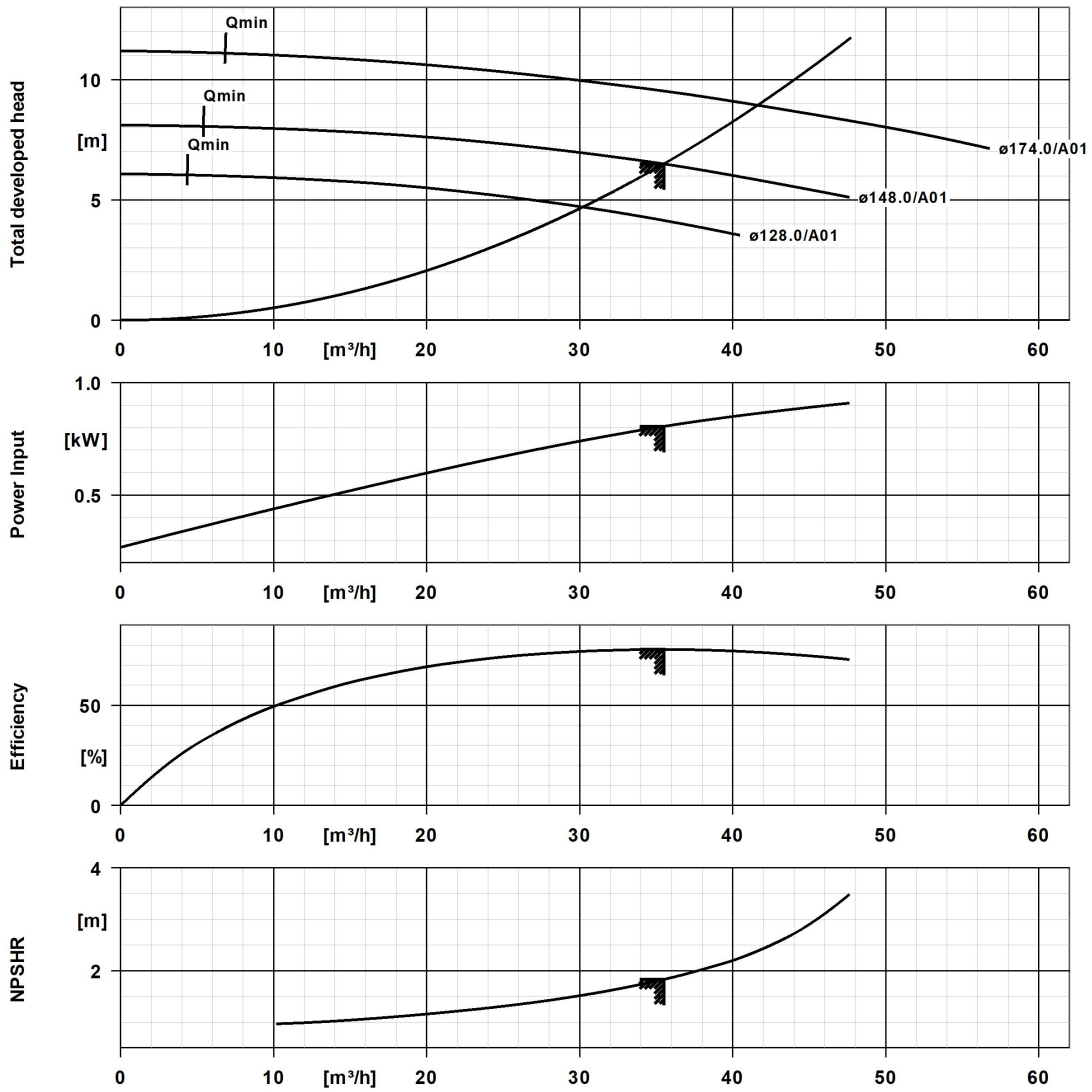

Curve Data

Pump speed	1.456 1/min	Efficiency Pump	77,9 %
Density Fluid handled	998 kg/m ³	Minimum efficiency index MEI	0,7
Kinematic viscosity Fluid handled	1 mm ² /s	Maximum power input at duty point	0,81 kW
Flow rate	35,5 m ³ /h	NPSH required	1,83 m
Head	6,5 m	Hydraulic impeller diameter	148 mm
		Hydraulic calculation according to standard/class	EN ISO 9906 Class 3B

Etabloc 065-050-160 GG
 ETB 065-050-160-GGSBV10 WSEBA4HHB

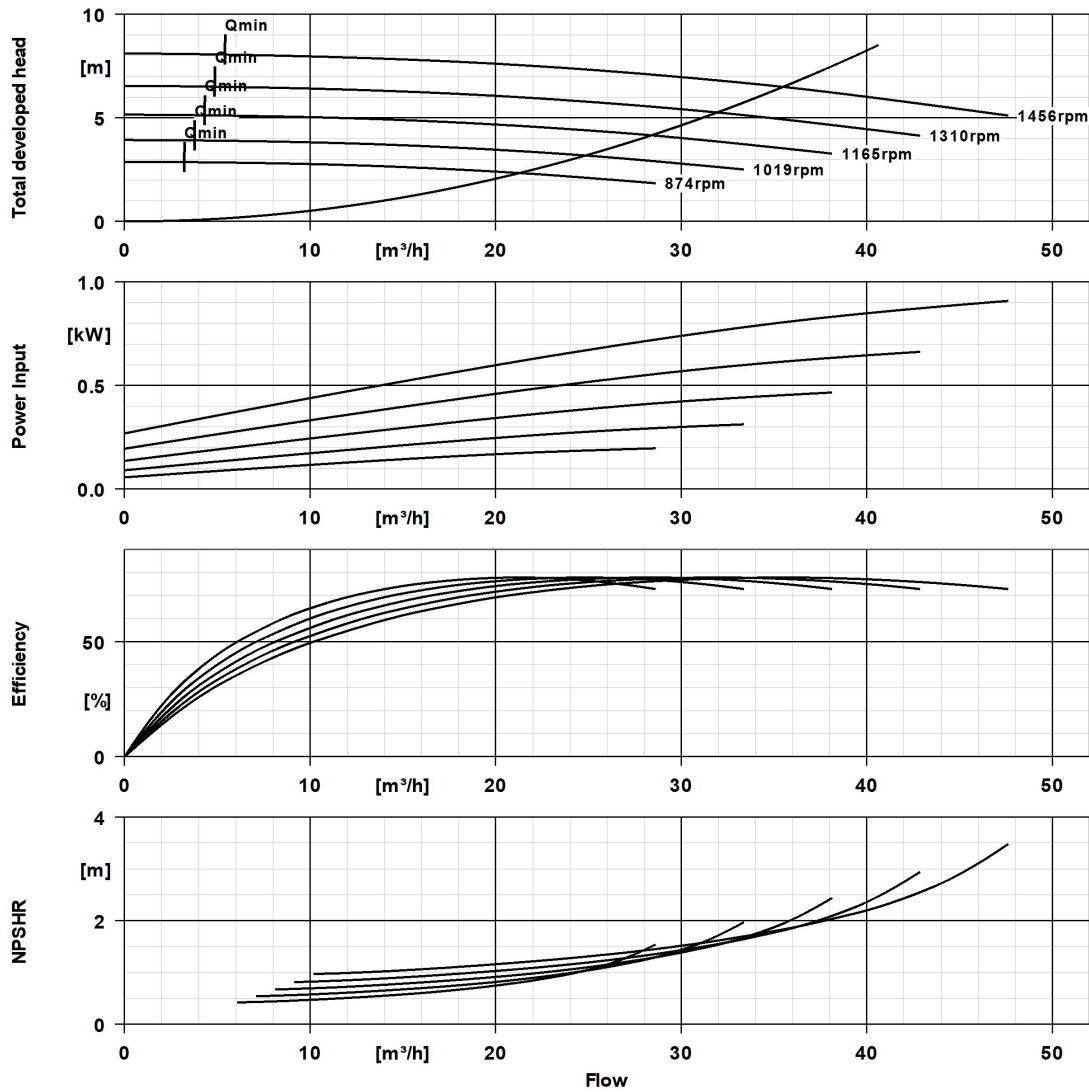

Curve Data

Density Fluid handled	998 kg/m^3	Minimum efficiency index MEI	0,7
Kinematic viscosity Fluid handled	1 mm^2/s	Hydraulic impeller diameter	148 mm
Flow rate	35,49 m^3/h	Head	6,498 m

Etabloc 065-050-160 GG
 ETB 065-050-160-GGSBV10 WSEBA4HHB

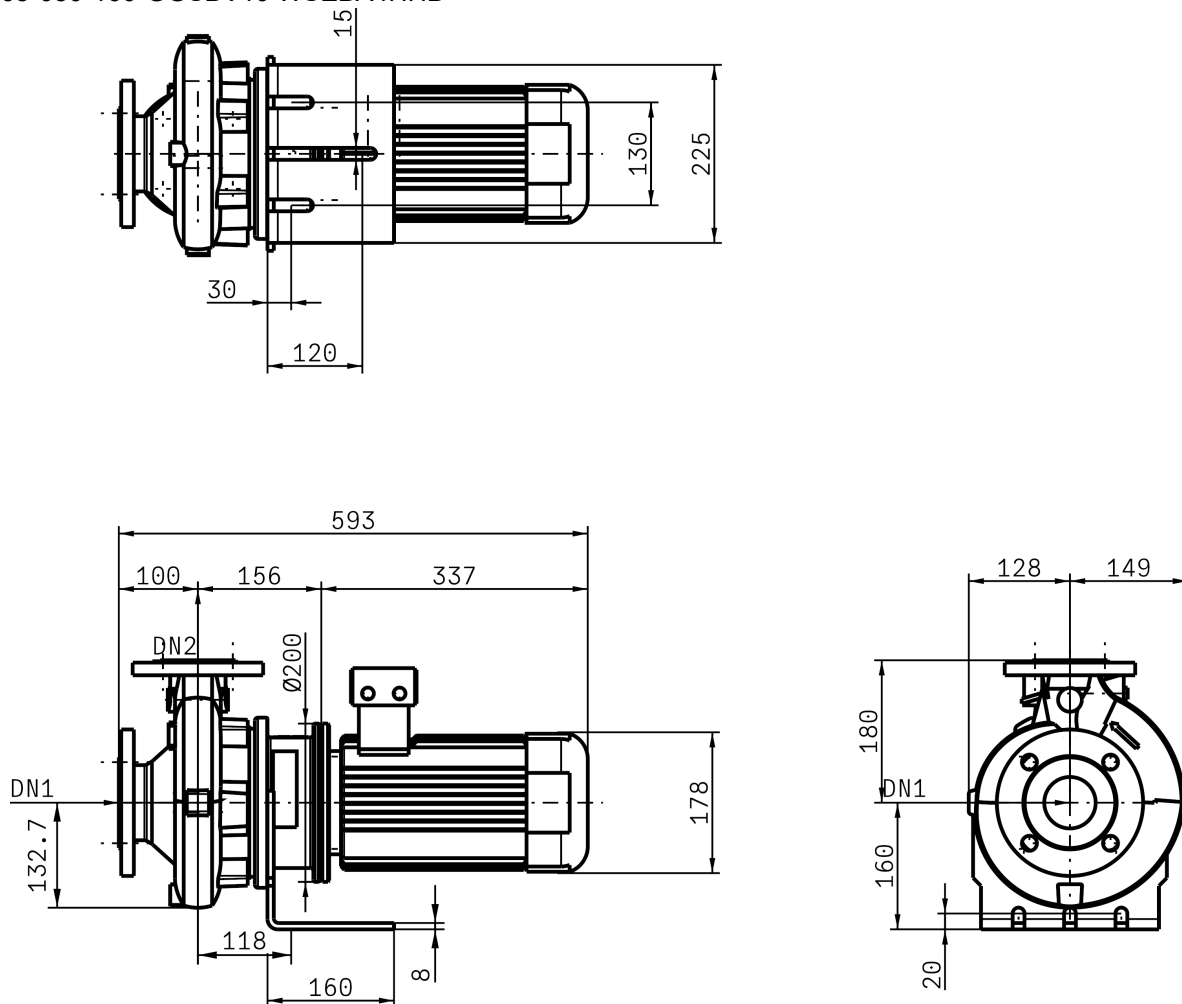

Drawing is not to scale.

Dimensions are given in mm

Motor

Motor manufacturer	KSB's choice
Motor size	90S
Rated power Motor	1,1 kW
Number of motor poles	4
Rated speed Motor	1.440 1/min
Terminal box position of motor (looking at the motor shaft)	360 °

Connections

Nominal diameter Suction nozzle	DN 65
Suction flange bolt hole pattern as per standard	EN1092-2
Nominal diameter Discharge nozzle	DN 50
Discharge flange bolt hole pattern as per standard	EN1092-2
Nominal pressure Suction nozzle	PN 16
Nominal pressure Discharge nozzle	PN 16

Net weight

Total weight Pump	32,1 kg
Total weight Drive	23 kg
Total weight Pump set	55,1 kg

Etabloc 065-050-160 GG

ETB 065-050-160-GGSBV10 WSEBA4HHB

Connect pipelines stress-free

Dimensional tolerances for shaft axis height: DIN 747

Dimensions without tolerances, middle tolerances to: ISO 2768-m

Connection dimensions for pumps: EN735

Dimensions without tolerances - welded parts: ISO 13920-B

Dimensions without tolerances - gray cast iron parts: ISO 8062-CT9

Plan for additional connections see extra drawing